

STEPS Palletizing Solution

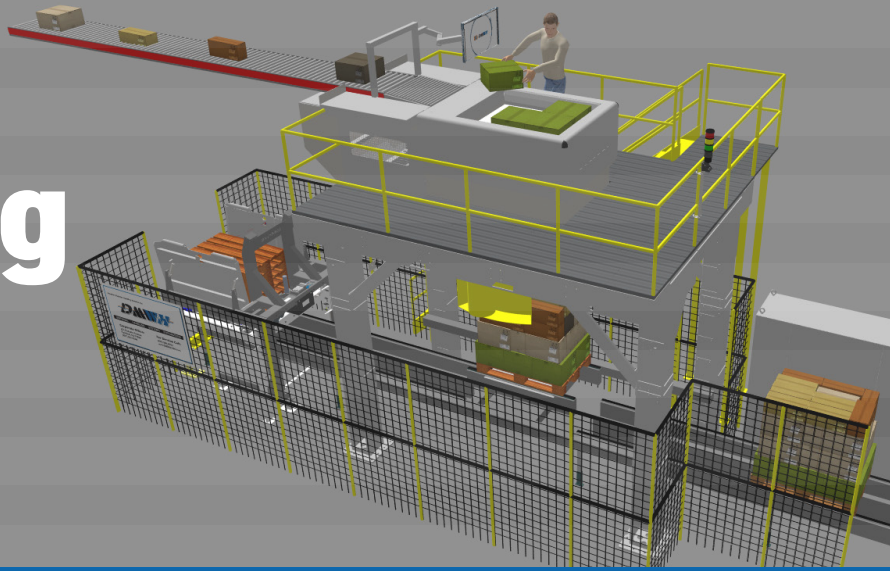

DRIVING Mixed Case Palletizing

DMW&H's STEPS Palletizing Solution targets inefficient end of line mixed palletizing operations. With skilled labor shortages and increasing SKU counts, STEPS aims to increase the productivity and throughput of your mixed load requirements. DMW&H offers a wide variety of back-end solutions, providing the proper carton feed to maximize rate of the semi-automatic load stations.



Key Benefits

- High-rate mixed case palletizing
- Maximize outbound truck cube volume
- Ergonomic work height
- Integrated load wrapping
- Simple to use for non-skilled workforce



Actual Results

- Up to 1,000 cases per hour
- Two-year ROI
- Easily integrated into existing environments

About DMW&H

With more than a half-century of experience, DMW&H has refined a unique approach to automated solutions. We design, integrate, install, and support complex material handling programs that deliver complete, collaborative automation solutions that will meet or exceed your fulfillment and distribution needs.

Let's Connect

WEBSITE | www.dmwandh.com

EMAIL | info@dmwandh.com

PHONE | 201-933-7840

